

FRIGIDAIRE®

96% AFUE Gas Furnaces



All gas furnaces feature SmartLite® Control Boards

FG7T(E, N)-VS

96% AFUE Ultra High Efficiency, Direct Vent or Non-Direct Vent, Condensing, 2-Stage (Dedicated Upflow, Downflow), iQ Drive ready, 60,000 - 120,000 BTUH Input, Variable-Speed Blower technology



FG7T(E, N)-FS

96% AFUE Ultra High Efficiency, Direct Vent or Non-Direct Vent, Condensing, 2-Stage (Dedicated Upflow, Downflow), ECM Blower technology, 60,000 - 120,000 BTUH Input



95.1% AFUE Gas Furnaces



FG7TC-VS

95.1% AFUE Extra High Efficiency, Direct Vent or Non-Direct Vent, Condensing, 2-Stage, Upflow/Horizontal, iQ Drive ready, 60,000 - 120,000 BTUH Input, Variable-Speed Blower technology



FG7TC-FS

95.1% AFUE Extra High Efficiency, Direct Vent or Non-Direct Vent, Condensing, 2-Stage Upflow/Horizontal, ECM Blower technology, 60,000 - 120,000 BTUH Input



95% AFUE Gas Furnaces

FG7S(D, M)

95% AFUE High Efficiency, Direct Vent or Non-Direct Vent, Condensing, 1-Stage, (Upflow/Horizontal, Downflow), Multi-Speed PSC Blower Motor, (38,000 - 120,000, 54,000 - 118,000) BTUH Input



92.1% AFUE Gas Furnaces

FG7S(C, L)

92.1% AFUE High Efficiency, Direct Vent or Non-Direct Vent, Condensing, 1-Stage, (Upflow/Horizontal, Downflow), Multi-Speed PSC Blower Motor, (38,000 - 120,000, 54,000 - 120,000) BTUH Input



80% AFUE Gas Furnaces

FG7T(A, K)-VS

80% AFUE Mid Efficiency, 2-Stage (Upflow/Horizontal, Downflow), iQ Drive Ready, 60,000 - 140,000 BTUH Input, Variable-Speed Blower



FG7T(A, K)-FS

80% AFUE Mid Efficiency, 2-Stage (Upflow/Horizontal, Downflow), ECM Blower technology, 60,000 - 140,000 BTUH Input

FG7S(A, K)-FS

80% AFUE Standard Efficiency, 1-Stage (Upflow/Horizontal, Downflow), Multi-Speed PSC Blower Motor, (45,000 - 126,000, 54,000 - 126,000) BTUH Input



96% AFUE Gas Furnaces



KG7T(E, N)-FS

96% AFUE Ultra High Efficiency, Direct Vent or Non-Direct Vent, Condensing, 2-Stage (Dedicated Upflow, Downflow), ECM Blower technology, 60,000 - 120,000 BTUH Input



95.1% AFUE Gas Furnaces



KG7TC-FS

95.1% AFUE Extra High Efficiency, Direct Vent or Non-Direct Vent, Condensing, 2-Stage Upflow/Horizontal, ECM Blower technology, 60,000 - 120,000 BTUH Input



Up to 95% AFUE Gas Furnaces

KG7SD-E

Up to 95% AFUE High Efficiency, Direct Vent or Non-Direct Vent, Condensing, 1-Stage Upflow/Horizontal, ECM Blower technology, 38,000 - 120,000 BTUH Input



95%/92.1% AFUE Gas Furnaces

KG7S(D, M)/KG7S(C, L)

95% AFUE/92.1% AFUE High Efficiency, Direct Vent or Non-Direct Vent, Condensing, 1-Stage (Upflow/Horizontal, Downflow), Multi-Speed PSC Blower Motor, (38,000 - 120,000, 54,000 - 118,000)/ (38,000 - 120,000, 54,000 - 120,000) BTUH Input



80% AFUE Gas Furnaces

KG7T(A, K)-FS

80% AFUE Mid Efficiency, 2-Stage (Upflow/Horizontal, Downflow), ECM Blower technology, 60,000 - 140,000 BTUH Input



KG7S(A, K)

80% AFUE Standard Efficiency, 1-Stage (Upflow/Horizontal, Downflow), Multi-Speed PSC Blower Motor, (45,000 - 126,000, 54,000 - 126,000) BTUH Input



Convertible Airflow Packaged Systems

All gas/electric and iHybrid® packaged systems feature SmartLite Control Boards

R6GI

Ultra High Efficiency, Gas/Electric, iQ Drive Technology, functions with 2-Stage Gas Heat/5-Stage Cooling output from 2-Stage thermostat, Variable-Speed ECM Blower, Square Duct Connections, Convertible Airflow, 20 SEER, 81% AFUE, Up to 13 EER, 2 - 5 Ton, 80,000 - 120,000 BTUH Input



R6GF

Gas/Electric, 2-Stage Heat & Cool, Variable-Speed Blower, Square Duct Connections, Convertible Airflow, 15 SEER, 81% AFUE, 12 EER, 2 - 5 Ton, 80,000 - 120,000 BTUH Input



DF6SF

iHybrid Dual Fuel, 2-Stage Gas Heat/2-Stage Cooling, Variable-Speed Blower, Square Duct Connections, Convertible Airflow, 15 SEER, 8.0 HSPF, 81% AFUE, 12 EER, 2 - 5 Ton, 80,000 - 120,000 BTUH Input



R8HE

Gas/Electric, 2-Stage Heat, Square Duct Connections, Convertible Airflow, 14 SEER, 95% AFUE, up to 12 EER, 2 - 5 Ton, 60,000 - 96,000 BTUH Input



R8GE

Gas/Electric, Square Duct Connections, Convertible Airflow, 14 SEER, 81% AFUE, 11 EER, 2 - 5 Ton, 45,000 - 120,000 BTUH Input



All packaged systems feature enhanced coil technology

Convertible Airflow Packaged Systems continued

P8SE

Air Conditioner, Square Duct Connections, Convertible Airflow, 14 SEER, up to 11.5 EER, 3, 4 and 5 Ton



Q8SF

Heat Pump, 2-Stage, Hot Gas Defrost, Square Duct Connections, Convertible Airflow, 16 SEER, 8.2 HSPF, 12 EER, 2 - 4 Ton

Q6SE

Heat Pump, Square Duct Connections, Convertible Airflow, 14 SEER, 8.0 HSPF, 11 EER, 2 - 5 Ton

Horizontal Airflow Packaged Systems

P7RF

Air Conditioner, 2-Stage Cooling, 5 Speed ECM Blower, Round Duct Connections, 16 SEER, 12 EER, 2 - 5 Ton



Q7RF

Heat Pump, Patented Hot Gas Bypass Defrost Technology, 2-Stage Heating and Cooling, 5 Speed ECM Blower, Round Duct Connections, 16 SEER, 8.2 HSPF, 12 EER, 2 - 5 Ton



P7RE

Air Conditioner, Round Duct Connections, 14 SEER, 11 EER, 2 - 5 Ton

Q7RE

Heat Pump, Round Duct Connections, 14 SEER, 8.0 HSPF, 11 EER, 2 - 5 Ton



ENERGY STAR® certification is awarded to products designed to reduce energy consumption and utility costs.

To qualify, packaged systems must have a Seasonal Energy Efficiency Ratio (SEER) rating of 15.0 or higher and an Energy Efficiency Ratio (EER) of 12.0 or higher. Packaged heat pumps must also have a Heating Seasonal Performance Factor (HSPF) of 8.2 or higher.

Gas furnaces must have an AFUE of 95% or higher for northern states, at least 90% AFUE for southern states, have an approved energy efficient blower motor and cabinet air leakage of less than or equal to 2%.

Split system air conditioners and heat pumps must have a 15.0 SEER rating or higher and an EER of 12.5 or higher. Split system heat pumps must also have an HSPF of 8.5 or higher.

Split System Air Conditioners

FSA1BG
Ultra High Efficiency, 20 SEER, iQ Drive® Technology, 2, 3, 4 and 5 Ton Capacity



FSA1BF
Extra High Efficiency, Up to 16 SEER, 2-Stage, 2, 3, 4 and 5 Ton Capacity



ESA1BF/WSA2BF
Extra High Efficiency, Up to 16 SEER, 1-Stage, 2, 2-1/2, 3, 3-1/2 & 4 Ton Capacity



FSA1BE/ESA1BE
High Efficiency, Up to 15 SEER, 1-1/2 - 5 Ton Capacity



FSA1BD/ESA1BD
High Efficiency, Up to 14 SEER, 1-1/2 - 5 Ton Capacity



WSA2BE
High Efficiency, Up to 15 SEER, 1-1/2 - 3 Ton Capacity



WSA2BD
High Efficiency, Up to 14 SEER, 1-1/2 - 3 Ton Capacity



Split System Heat Pumps

FSH1BG
Ultra High Efficiency, Up to 19 SEER, 10.0 HSPF, iQ Drive Technology, 2, 3, 4 and 5 Ton Capacity



FSH1BF
Extra High Efficiency, Up to 16 SEER, 9.0 HSPF, 2-Stage, 2, 3, 4 and 5 Ton Capacity



ESH1BF/WSH2BF
Extra High Efficiency, Up to 16 SEER, 1-Stage, 2, 2-1/2, 3, 3-1/2 & 4 Ton Capacity



FSH1BE/ESH1BE
High Efficiency, Up to 15 SEER, 8.5 HSPF, 1-1/2 - 5 Ton Capacity



WSH2BE
High Efficiency, Up to 15 SEER, 8.2 HSPF, 2 - 3-1/2 Ton Capacity



Frigidaire units offer a 10 year Limited Warranty on all parts when registered. Plus the Comfort Quality Pledge on select models, which states if within the first 10 years the compressor or furnace heat exchanger fails Frigidaire will replace the entire unit, registration required. ESA/ESH & KG7 models carry a 1 year Quality Pledge when registered. Air handlers and coils carry a 5-year all parts limited warranty and when installed with a matched outdoor unit, will carry the outdoor system warranty. W models carry a 3-year all parts limited warranty and a 3-year compressor warranty. Accessories carry the 10 Year Limited Parts Warranty when installed and registered with a complete system. See warranty for details.



Air Handlers

B6VMAX
Multi-Poised, Vertical/Horizontal, Variable-Speed, TXV



B6VMMX
ECM Variable-Speed Motor, Multi-Poised, TXV



B6BMMX
Multi-Poised, Vertical/Horizontal, Multi-Speed, TXV



B6BMMO
Multi-Speed, Multi-Poised



B6EMMX
ECM Fixed-Speed Motor, Multi-Poised, TXV



B6BW
Vertical Wall Mount

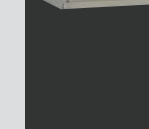

B6EW
Vertical Wall Mount, Multi-Speed, ECM Motor, TXV

Indoor Coils

C7B(A, H)MO
A, B, C and D sizes available in various capacities

Cased & Uncased, Vertical/Horizontal, Multi-poised versions available



C7B(A, H)MX
Factory-installed TXV, A, B, C and D sizes available in various capacities

Cased & Uncased, Vertical/Horizontal, Multi-poised versions available



C6BH-X
A, B, C and D sizes available in various capacities

Cased, Uncased & Horizontal versions available



System Accessories

Air Cleaners Electronic Air Cleaner
Lifetime filtering systems, removes household allergens and pollutants down to .01 microns

Media Air Cleaner
MERV 14, long life media filter, removes airborne particles down to 0.3 microns



System Accessories

Air Cleaners continued
1" Electronic Air Cleaner
Easy to maintain, 24V, 95% efficient down to .01 microns

HEPA Air Cleaner
High efficiency air filtration, captures 99.97% of harmful airborne pollutants

Thermostats
Universal, Programmable 7-day, 24V, digital, up to 3 heat/2 cool, backlit display + keypad, auto or manual changeover

UV Air Treatment Systems
UV object purifiers and Photo Catalytic Oxidation (PCO) units remove mold, bacteria, and viruses that are found in the air stream and also remove odors from the home.

Humidifiers
Eliminates parched, dry air which can cause dry nose & throat, itchy & dry skin by delivering humidity and reducing static electricity



FRIGIDAIRE

FRIGIDAIRE is a registered trademark used under license from Electrolux Home Products, Inc. © Nortek Global HVAC, LLC 2019. All Rights Reserved.

iHybrid®, iQ Drive®, ecoLogic® and SmartLite® are registered trademarks of Nortek Global HVAC, LLC. Specifications and illustrations subject to change without notice and without incurring obligation.

COMFORT THAT FITS YOUR LIFE

frigidairehvac.com

122C-0419